

SOUTH PACIFIC BY DESIGN

powered by  DISCOVER HOLIDAYS

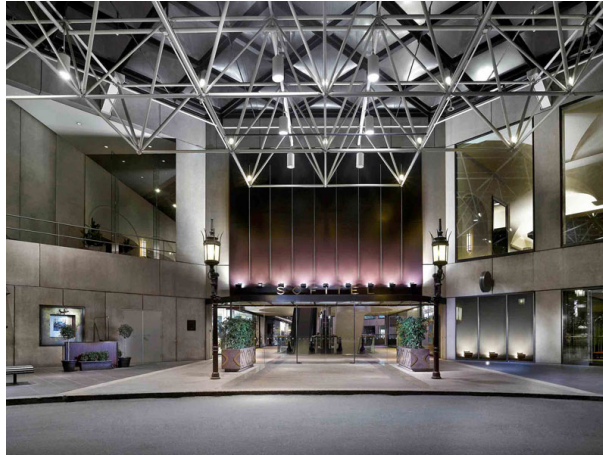

Sofitel Melbourne on Collins

Signature Hotels & Resorts

Priced at USD \$251 avg/ night incl all taxes

Price is an indication based on peak season rates.

Contact us for low season pricing and specials.

INTRODUCTION

Sofitel Melbourne on Collins brings French luxury and local cuisine to the world's most exciting city. Perfectly situated at the end of prestigious Collins Street, guests of this sophisticated hotel will find themselves surrounded with premier dining, shopping and entertainment options, and thrilled with the incredibly close proximity to the famous Cricket Ground. The hotel itself has 363 rooms, starting from the 36th floor to ensure breathtaking views of the city. So grab a drink at one of two bars, or settle in for a delicious meal of modern cuisine – then toast to the magic that is Sofitel Melbourne on Collins.



LOCATION

Standing proudly at the 'Parisian' end of Collins street, the Sofitel Melbourne on Collins is steps away from the city's

SOUTH PACIFIC BY DESIGN

Start planning your tailor-made vacation in Australia, Fiji and New Zealand by contacting our South Pacific specialists

Call 1 855 465 1030 (Monday - Saturday 9am - 5pm Pacific time)

Email sales@southpacificbydesign.com Web southpacificbydesign.com

Suite 1200, 675 West Hastings Street, Vancouver, BC, V6B 1N2, Canada

finest restaurants, shops and entertainment options. The airport is an approximate 30 minute drive away, and the Athenaeum Melbourne, Princess Theatre and Her Majesty's Theatre are all easily within walking distance.

MAP

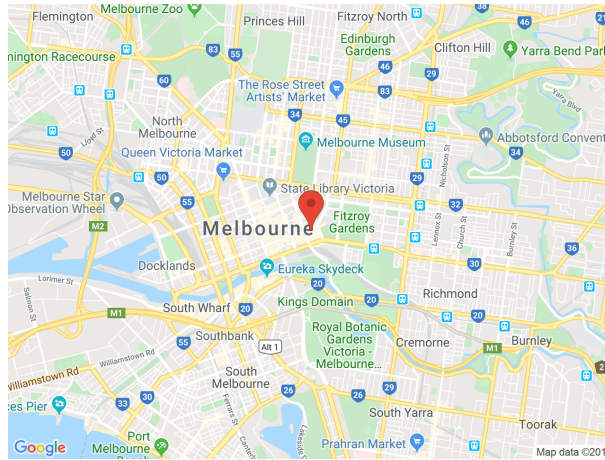

SOUTH PACIFIC BY DESIGN

Start planning your tailor-made vacation in Australia, Fiji and New Zealand by contacting our South Pacific specialists

Call 1 855 465 1030 (Monday - Saturday 9am - 5pm Pacific time)

Email sales@southpacificbydesign.com Web southpacificbydesign.com

Suite 1200, 675 West Hastings Street, Vancouver, BC, V6B 1N2, Canada